

Issue 15

In this issue, attach the radiator grille to the front bumper assembled in Issue 9, then fit the right-hand MacPherson strut to the front axle assembled up to Issue 14.

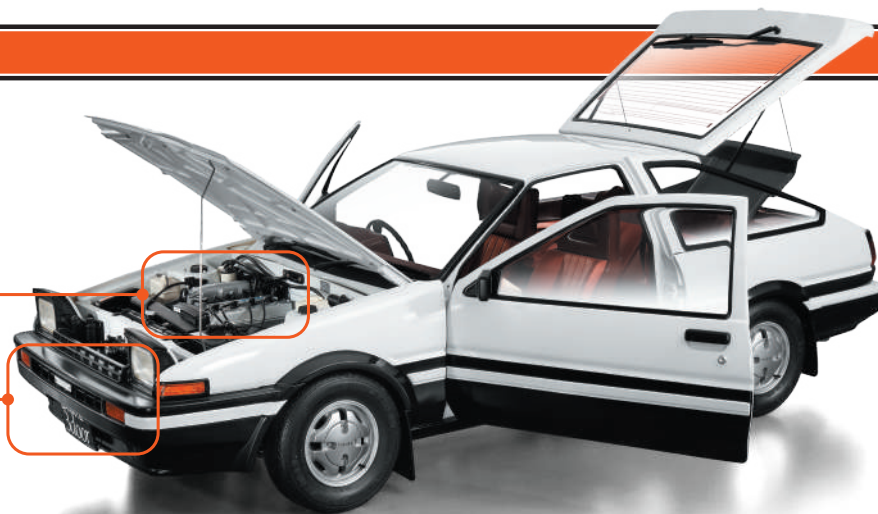

Fit the Radiator Grille and Assemble the MacPherson Strut

※ In this guide "Left" or "(L)", and "Right" or "(R)", refer to the direction as viewed from the driver's seat.

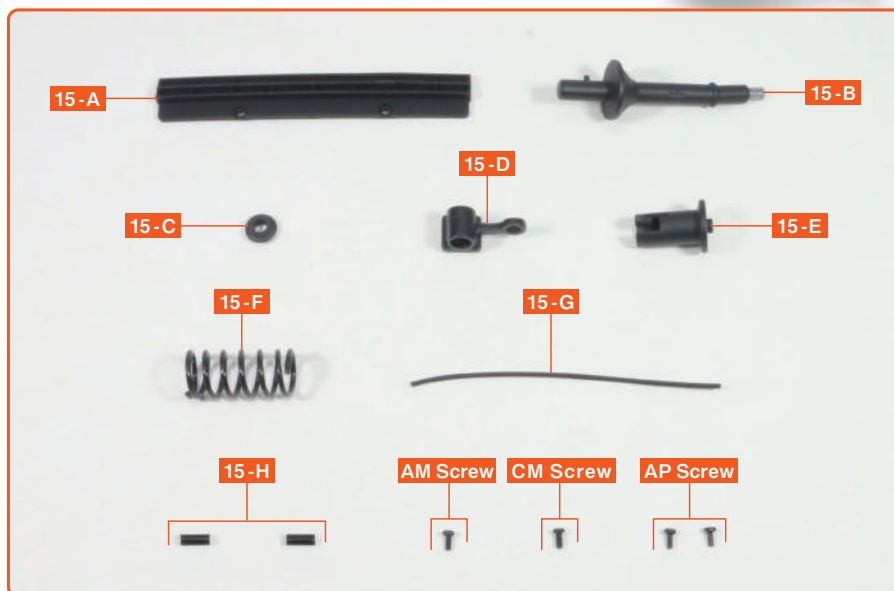

15-A Radiator Grille

15-B MacPherson Strut (R)

15-C Washer

15-D Knuckle Arm (R)

15-E Strut Upper Mount (R)

15-F Front Coil Spring

15-G Cold Start Injector Lead

15-H Code Band x2

AM Screw (1.7×4mm) ×1+Spare

CM Screw (2.0×4mm) ×1+Spare

AP Screw (1.7×4mm) ×2+Spare

View the follow-along video



※Due to the model's design, the shapes of some parts may differ from those of the real vehicle.

step 1 Prepare the wiring

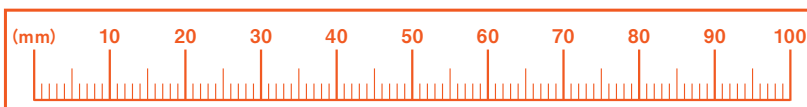

Cut the wiring for step 4 from the vinyl tube saved in Issue 12. Cut it to 80 mm to make the **Throttle Position Sensor lead 15-I**. Use the ruler shown on the left, or make a tool like the one in the photo below, and measure the length as you cut with a craft knife or scissors.

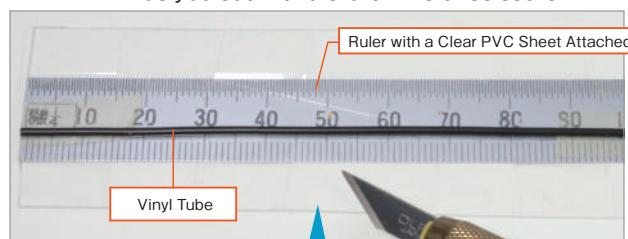
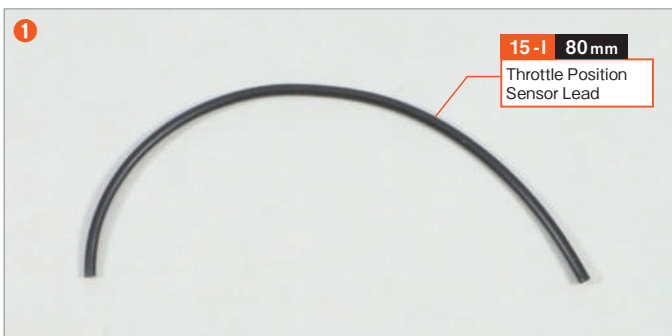

To prevent scratches, attach a clear PVC sheet to a ruler, lightly secure the vinyl tube with double-sided tape, and cut it with a craft knife.

step 2 Install the Radiator Grille

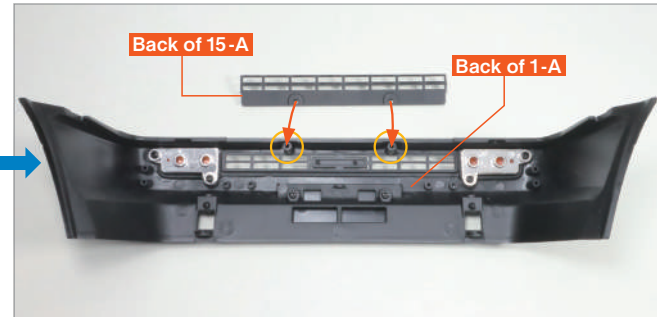

Prepare the front bumper assembled in Issue 9, and align the two screw-hole projections on the back of **Front Bumper 1-A** with the recesses on the back of **Radiator Grille 15-A**.

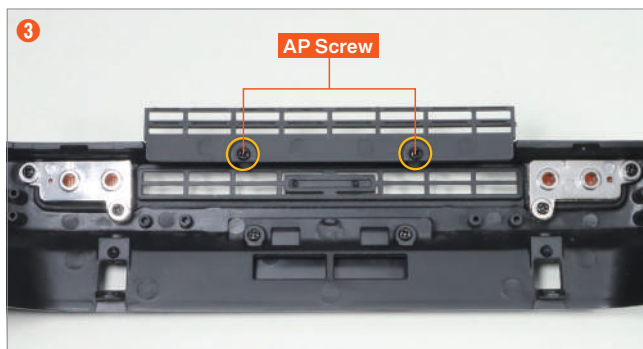

Secure at two points with **AP screws**.

Step complete



step 3 Assemble the right MacPherson strut

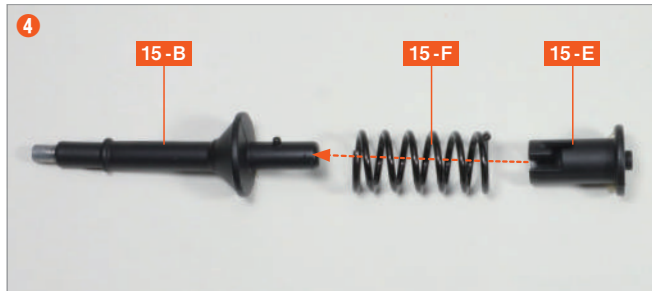

Slide the **Front Coil Spring 15-F** onto the end of the **MacPherson Strut (R) 15-B**, then fit the **Strut Upper Mount (R) 15-E**.

If **15-F** is stiff, wrap it in a towel and press it on firmly. Refer to step 1 in Issue 5 as well.



Follow the numbered sequence in the photo: while pressing **15-F**, insert **15-E** and pass the projection on **15-B** through the notch on **15-E**. When the projection meets resistance, rotate **15-E** downward and secure it so it doesn't come loose.



Fit the **Knuckle Arm (R) 15-D** and **Washer 15-C** onto the other end of **15-B**.

Orient **15-C** with the chamfered side facing outward.



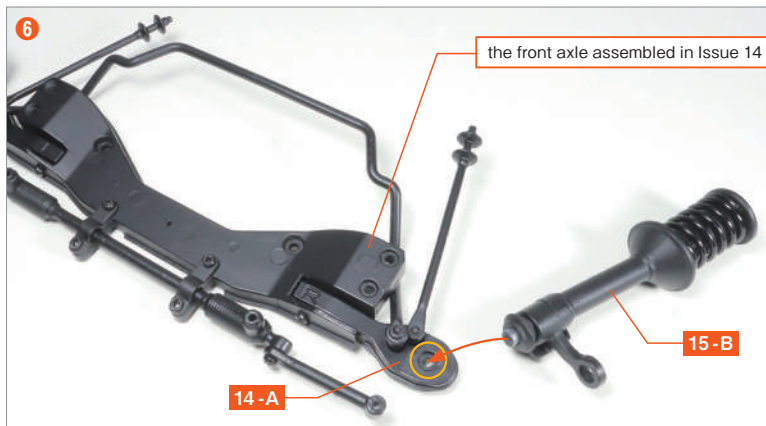

Prepare the front axle assembled in Issue 14, and align the tip of **15-B** with the recessed screw hole in the **Front Lower Arm (R) 14-A**.

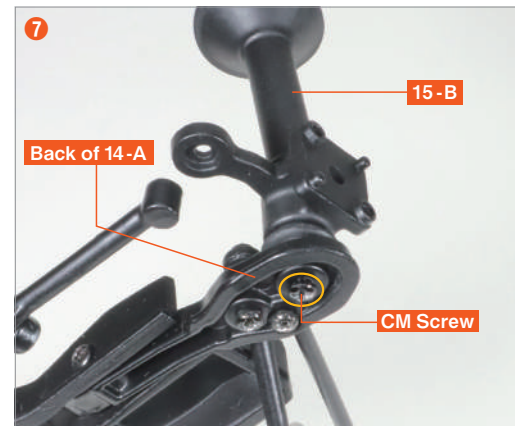

Turn the front axle over and fasten **14-A** from the back with a **CM screw**. Be careful not to tighten it too much, so that **15-B** can rotate freely.



Align the screw hole of **15-D** with that of the **Tie Rod (R) 14-H**.

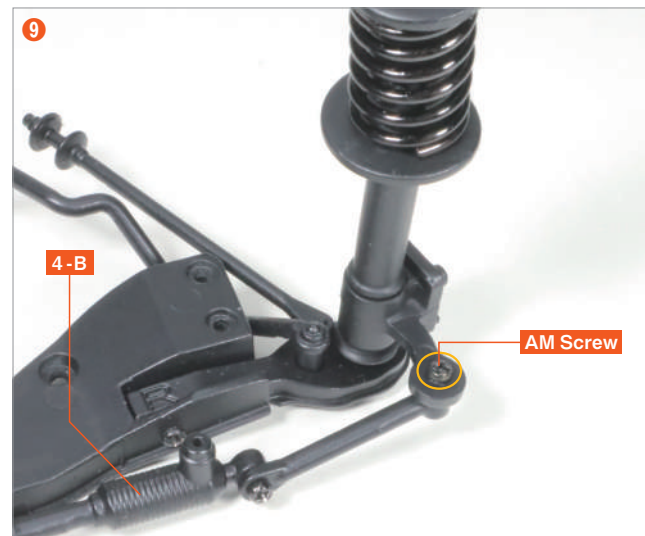

Secure with an **AM screw**. Do not overtighten, so that the **Steering Rack 4-B** can move freely from side to side.

step 4 Attach the lead

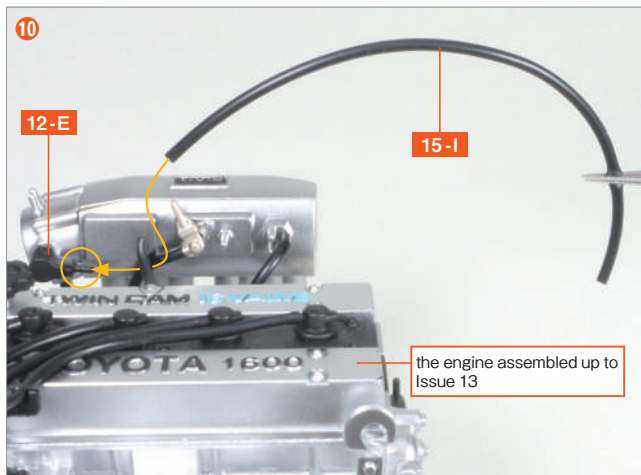

Prepare the engine assembled up to Issue 13, and insert the **15-I** cut in **step 1** onto the projection of the **Throttle Position Sensor 12-E**.

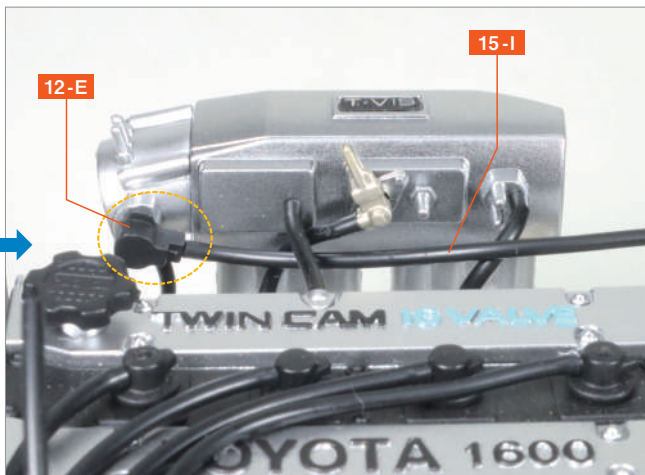

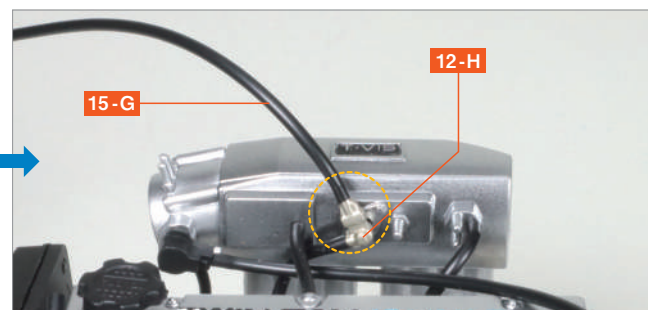
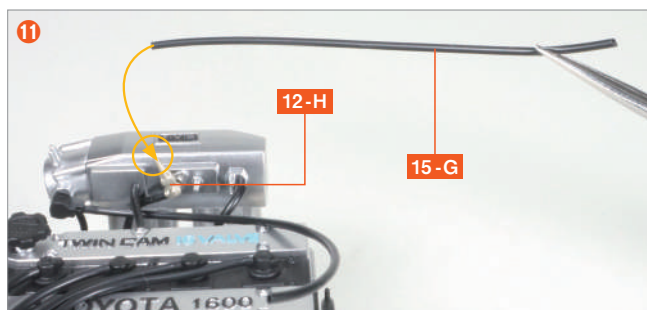

Insert **Cold Start Injector Lead 15-G** onto the protrusion of **Cold Start Injector 12-H**.

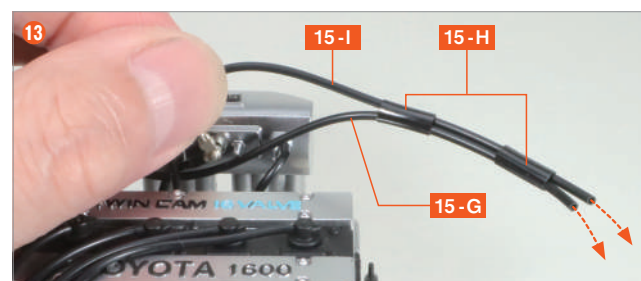
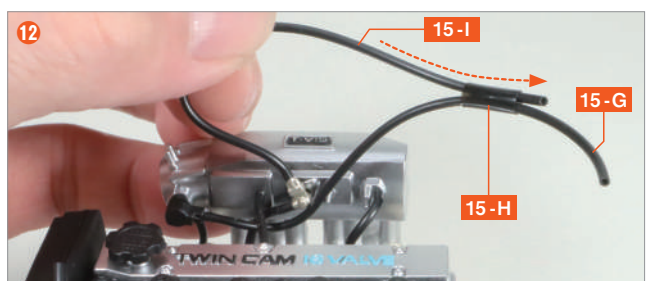

Thread Leads **15-G** and **15-I** through **Code Band 15-H** to bundle the two leads together.

Thread the other **Code Band 15-H** with Leads **15-G** and **15-I**. This bundles the two leads at two points.

Step complete

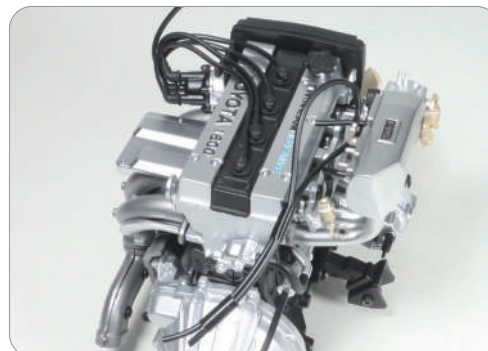

Complete

The assembly for Issue 15 is complete. The Front Grille has been attached to the Front Bumper. The Right MacPherson Strut has been fitted to the Front Axle, gradually revealing the steering mechanism. Throttle wiring has also been added to the engine, making each component interesting to display on its own. In Issue 16, we will fit the Right Disc Brake to the Front Axle.

